

F-Theta f=900mm

Drawing No. SH79-1064-600-900-20

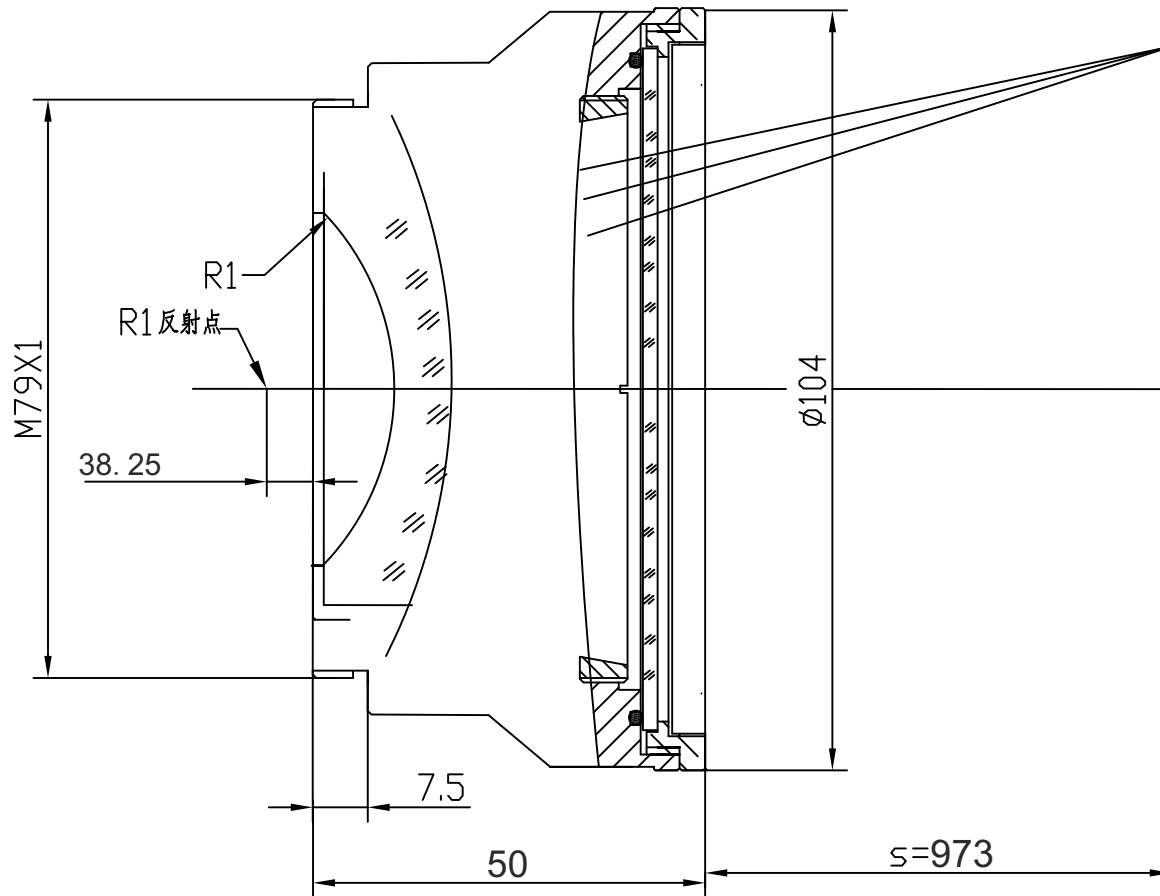

Specification

EFL	900mm
S	973mm
Wavelength	$\lambda = 1064\text{nm}$
scan angle	$\pm 28^\circ$
max scan field	600mm x 600mm
Entrance beam diameter \varnothing	20mm
Center point diameter ($1/e^2$)	88 μm
Edge point diameter ($1/e^2$)	90 μm
mirror distance m1	18
mirror distance m2	24
Transmission >	97%
Thread	M79x1
With protective window	yes